



Smithsonian Institution
National Museum of Natural History

Department of Anthropology
National Anthropological Archives

NAA MS 3207
Notes on Kickapoo naming ceremonies and clans collected
by Truman Michelson, undated
National Anthropological Archives, Smithsonian Institution

Please cite the material in the following format:

"NAA MS [Manuscript Number], National Anthropological Archives, Smithsonian Institution"

For example:

"NAA MS 2108, National Anthropological Archives, Smithsonian Institution"

Water (South side) Hosts }
 Eagle waiters }
 Turkey Hosts }

Eagle Host } 1
 Berry waiter }
 Berry Hosts }
 Turkey waiters }

i'ckatcima' l' later on = Fox

i'ckatc' = Fox a'ckatc' =

or Oj. also.

n'ckulä näl'ya'ö'iga = Spirit of Fire

ARCHIVES OF THE
 BUREAU OF
 AMERICAN ETHNOLOGY
 SMITHSONIAN INSTITUTION
 NO. 3207

nunägi' ä' ta' cigna' ciga' =

he looks with his face close to the smoke hole.

me' tegimiyagi' used only in feasts

ä' naga'mudci' he was singing.

nä'gasmudci' singers.

Elks Hosts }
 Bears waiters } ✓

Raccoons Hosts }
 Buffaloes^{1st choice} waiters } ✓

Bears Hosts }
 Wolves waiters } ✓

Buffalo Hosts }
 Thunder waiters } ✓

Wolf Hosts }
 Fox waiters } ✓

Thunder Host }
 Bear^{2nd choice} or Wolf^{1st} both }
 allowed. }
 2 part, take Fox. }

Fox Hosts }
 Raccoon waiters } ✓

Man Host }
 Buffalo^{2nd choice} waiters }
 Wolf^{1st} }
 2nd choice }

over

South side

North

1930

Wata

Elk

few left

Eagle

Bear

2

Bunny

Wolf

Turkey

Fox

Raccoon

mostly all gone.

Beaver

~~Bear~~

Bat

Tree

Kick

Ock -

If a man names his child must
be his side, his gun. If the woman, with
man's permission, "names" the child, her
father or maternal uncle, will be the side,
gun of the name.

Center,

The waiters

Man

must be of
the Hart's side.

Buffalo

Thunder

Wind about all gone.
But all dead.

supposed the later. Some K some T, any
way they want. But Hart

wind Hart

Raccoon, Fox,

Man & choice 3 waiters.
Buffalo

Wolf, Bear just
as it comes.

E South Side w.
Diagram 1

3

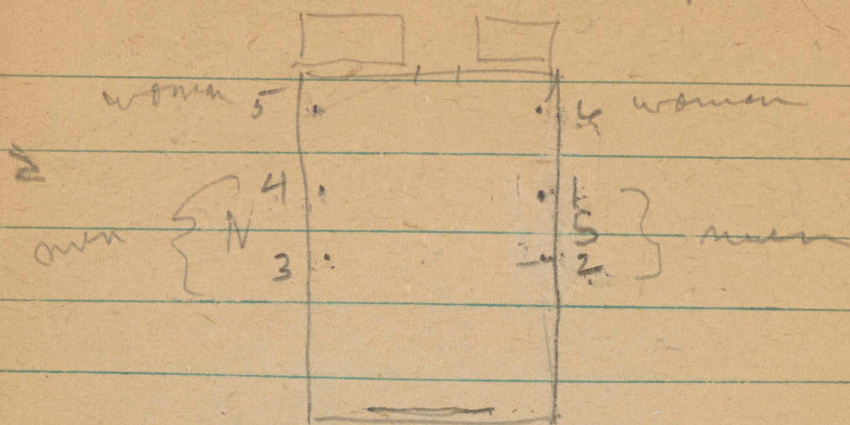

Water Chail d^W be named -

On West Water gens people as before -

- 1 Eagle 2 ^{Tree row} ~~Bear~~ 3. Bear (Elk ^{second choice})
4 Elk (H Bear, 2nd choice) 5. Elk (Bear 2^d choice) 6. Eagle (2nd choice (Tree)).

Other in cases other 5 on south side fail -
water: Eagles.

Water should be 1^W diagram

South Side
Eagle

4

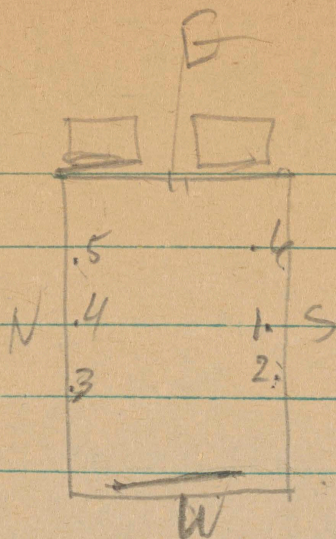

Should be
2nd diagram

Eagle child to be named

Eagle goes on the West.

1. Water. 2. Tree. 3. Bear. 4. Elk. 5. Elk.
to water.

Should be 2d diagram.

Waiters: Tree

5



✓

- 6 water

South Side

6

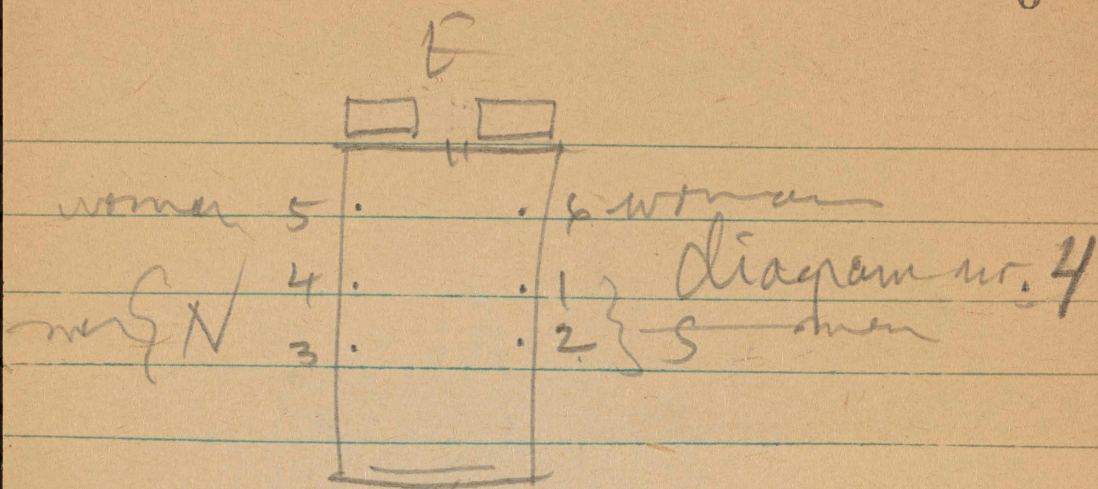

Bury child to be named.

Bury guns on the west.

1. water 2. Eagle 3. Bear 4. Elk 5. Elk
6. water -

Waiters. Turkey

South side

7

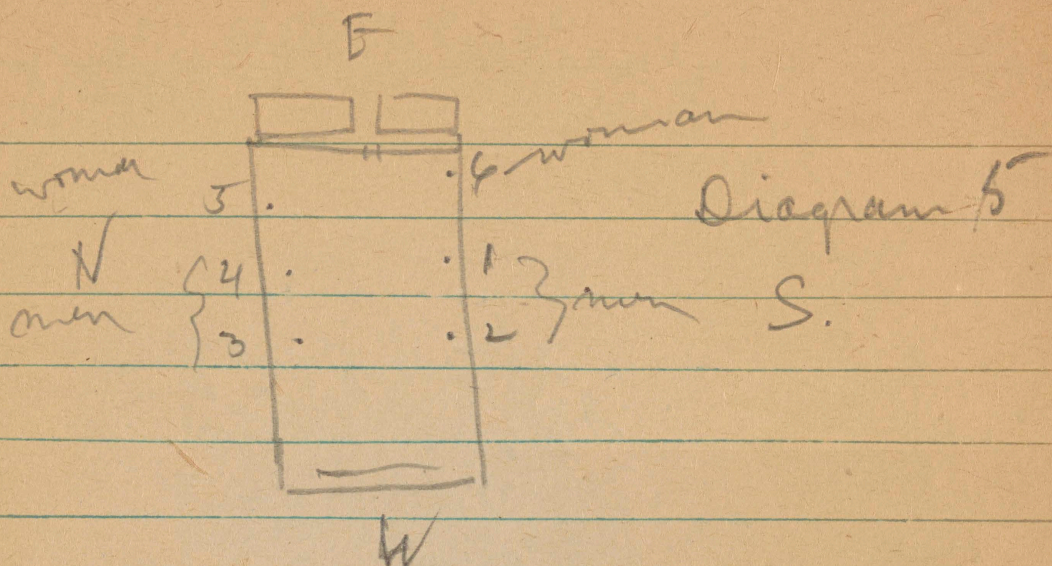

Turkey child to be named
Turkey guns on west.

1 Water 2. Eagle, 3 Bear 4 Elk.
5. Elk. 6 Water.

waiters: ~~Berries~~
Raccoons -

South side Diagram: or 6 Raccoon

8

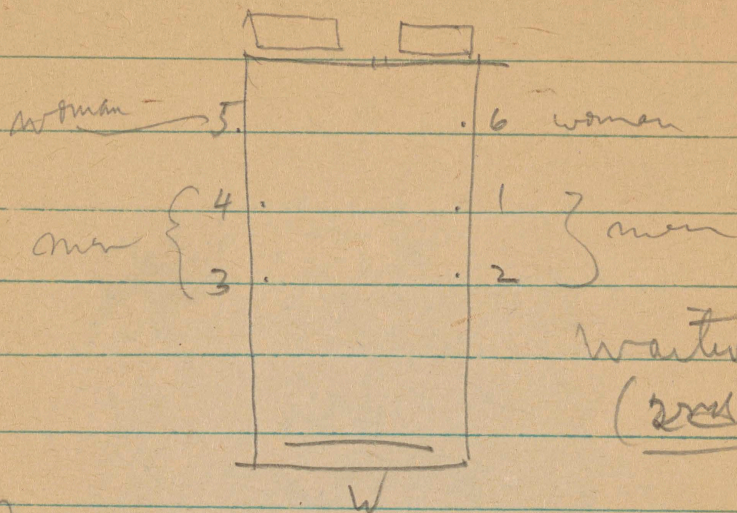

Raccoon gens on westside.

1 water. 2. Eagle. 3. Bear. 4. Elk. 5. Elk
6 water.

North Division
Diagram
Elk

9

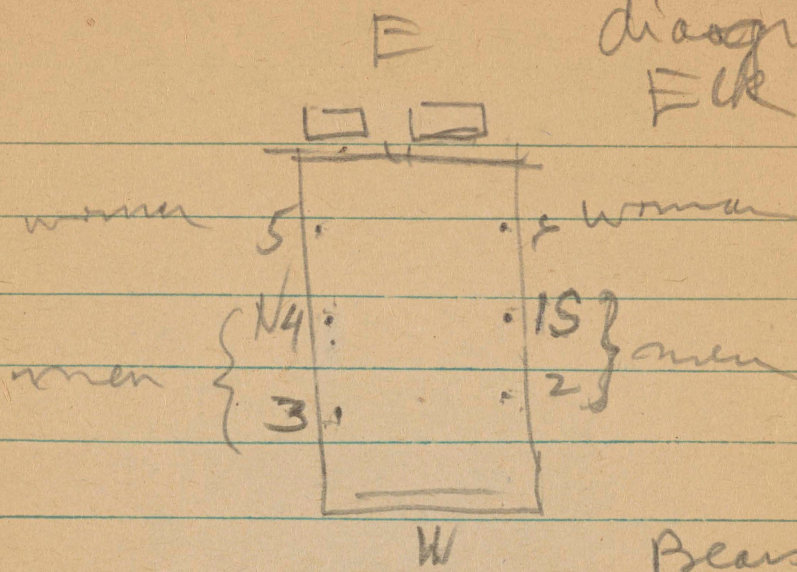

Bears: waiters

Elk Child to be named

Elk gens on west end.

1 Water

2 Eagle

3 Wolf

4 Bear

5 Bear

6 Water.

North Side
Diagram no 2 - E

10

Summer house
same arrangement
in wigwam.

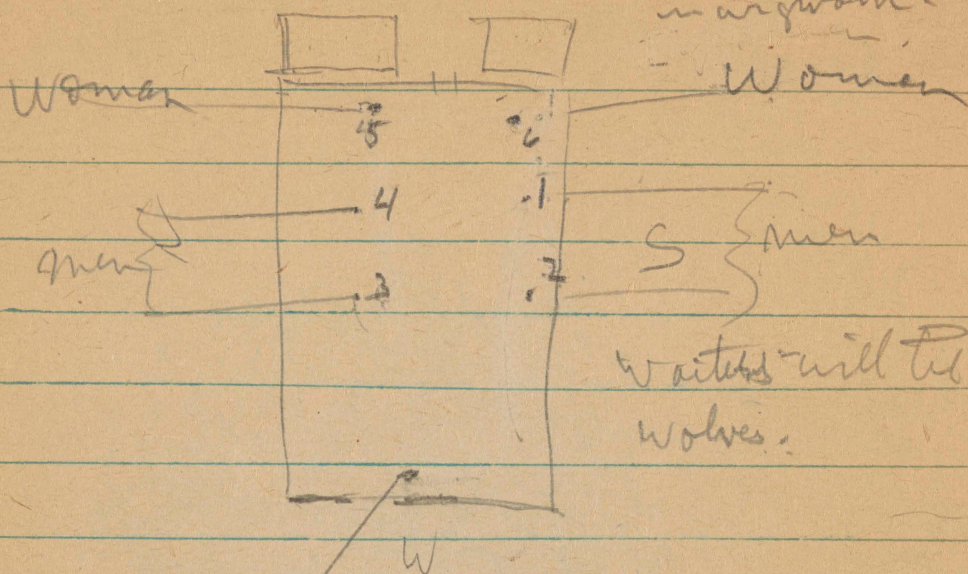

~~The~~ men & women who belong
to the gens of the child to be named.
Those on the North will be the
North gens & those on the South
will be the South gens.

= Bear gens child to be named.

Then the Bear gens men & women will be
on the west, as many as can be there.

1 Water. 2 Eagle. 3 Wolf. 4 Elk.
5 Elk. 6 Water

[K. + O. cut no figure.]

North

11

diagram 2

Bearshild

The named

see diagram several
pages above

North Side

Waters: Foxes

Diagram 3

12

Wolf Child to be named

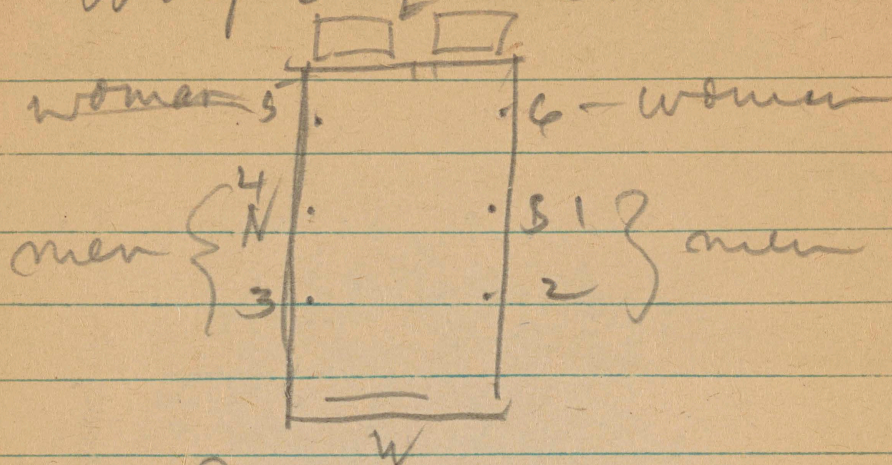

Wolf pups will be on West end.
See also above,

1 Water

2 Eagle

3 Bear

4 Elk

5 Elk

6 Water -

North side

13

E

no 3

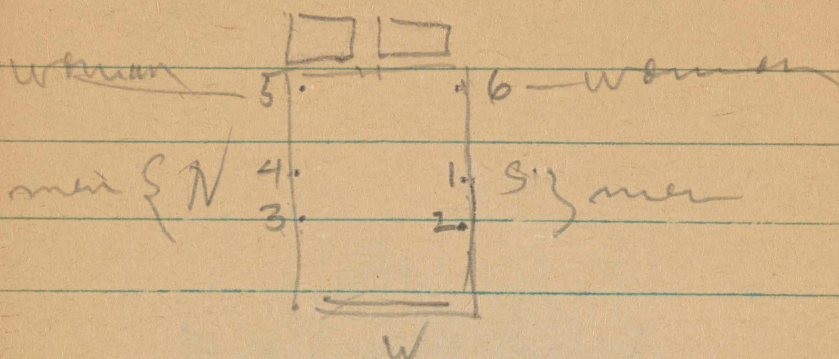

W old child & named.

Wolf on west.

1 Water. 2. Eagle. 3. Bear. 4 Elk.

5 Elk 6. Water.

waiter: Rocks.

North side diagram 4

14

Fox Child to be named

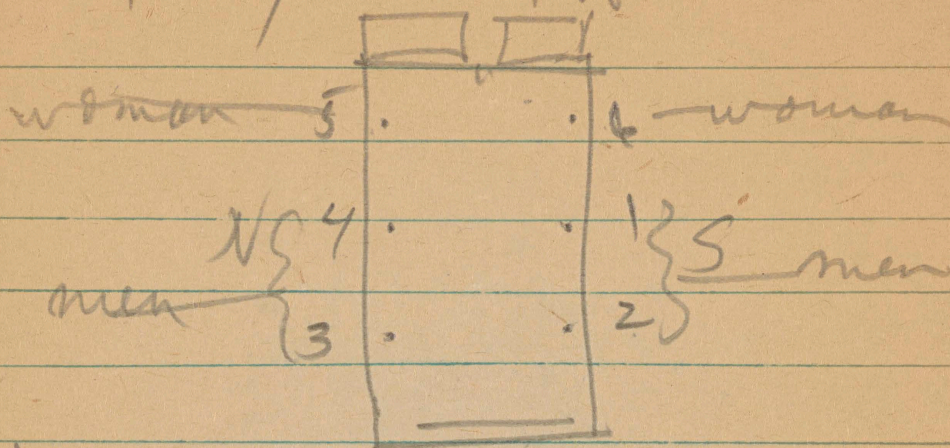

Foxgens on the end.

1. Water

2. Eagle

3. Bear

4. Elk

5. Elk

6. Water.

waters:

Beavers.

North side
5 Raccoon child to be named - 15

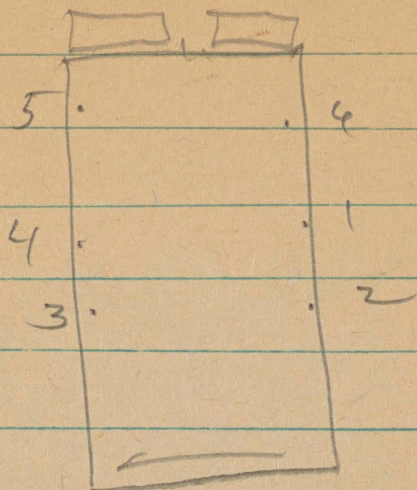

belong to
South side
1930

Waters: Thunder (1st choice;
Buffalo 2nd choice.)

1 Water

2 Eagle

3 Bear

4 Elk

5 Elk

6 Water -

North Side
nr 6 Beaver
B.

16

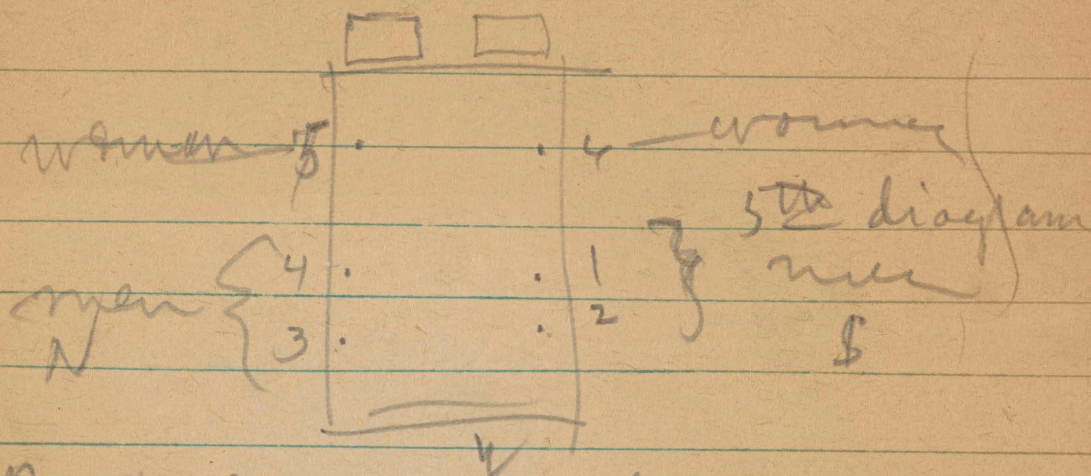

Beaver on west
1 water

2 Eagle

Waiters

3 Bear

Thunder, 1st choice

4 Elk

Buffalo 2nd "

5 Elk

6 water.

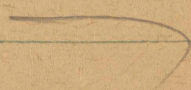

E
Center

17

Thunder. 1 diagram

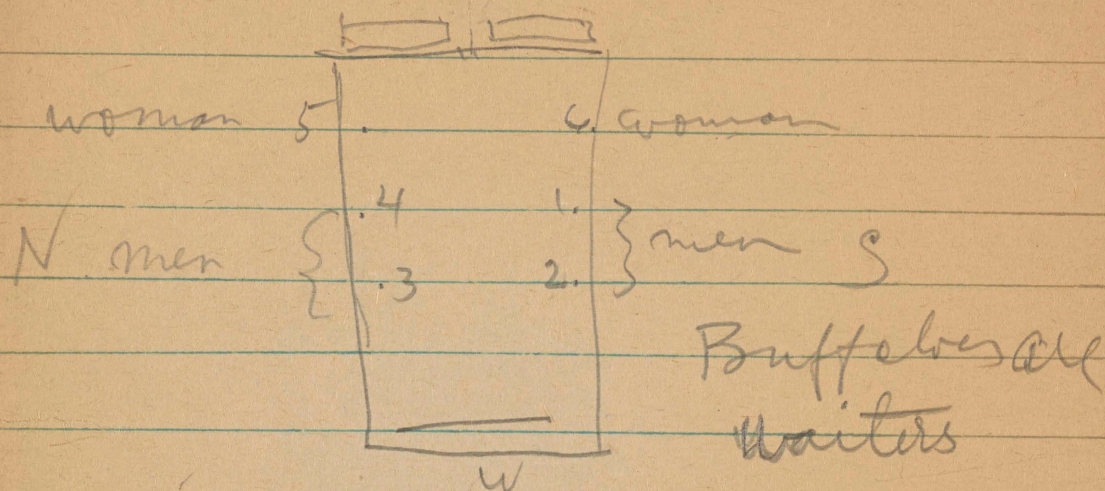

Thunder child to be named.

1 Water 2 Eagle 3 Bear 4 Elk
5 Elk 6. water.

Thunder gens on West

Center no 2.

18

Thunder gens child to be
E named.

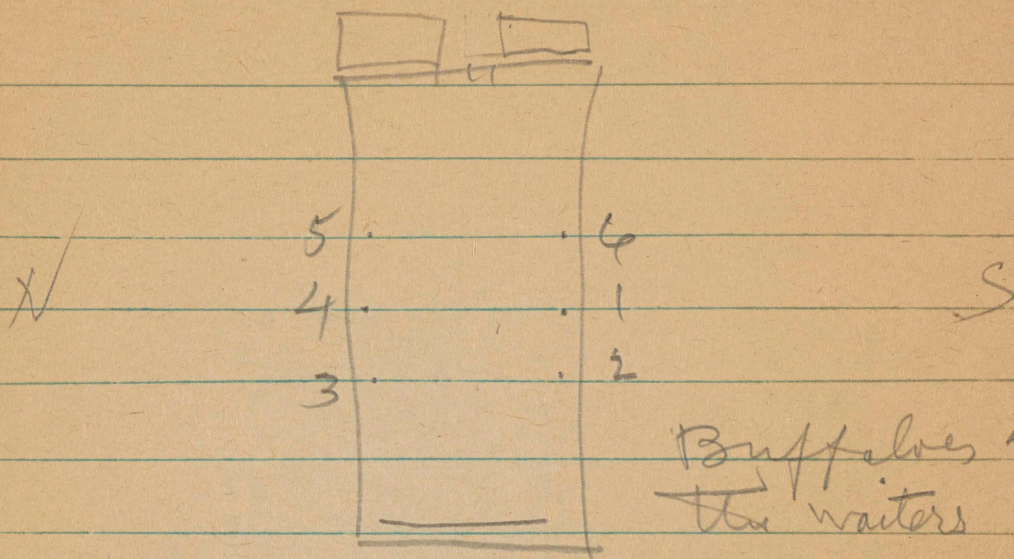

W

Thunder gens on West end.

1 Water. 2 Eagle 3 Bear. 4 Elk.
5 Elk. 6 Water.

BUREAU OF AMERICAN ETHNOLOGY
CATALOGUE OF MANUSCRIPTS

No. 3207

Stock Algonquian

Language Kickapoo Dialect _____

Description: (words, vocabulary, dictionary, grammar, text, legends, notes)

Collector Dr. T. Michelson - Informant: Joe Murdock

Place _____ Date _____

Remarks Naming diagrams, gens organizationa.

17 sheets 6 x 9". (1897)



Smithsonian Institution
National Museum of Natural History

Department of Anthropology
National Anthropological Archives

The Smithsonian continues to research information on its collections. Contact Smithsonian for current status.

Please observe the following rules for file sharing, which are intended to help protect the integrity of the material and associated information.

- Do not incorporate material into a publicly accessible database or website without checking with the National Anthropological Archives (NAA).
- Do not post whole manuscripts to a social media site, such as a blog, Facebook page, Twitter feed, etc;
- Do not modify or obscure the source information or copyright notice included in the material;
- If you deposit the material in a tribal library or resource center, make sure that the library or resource center knows the source of the original material and is aware of these rules. Please let the NAA know where material is deposited so that we can guide community members to it.

Questions? naa@si.edu.